



ROBERT SQUARE SHOPPING CENTER

1660-1726 Robert St. S | West St. Paul, MN 55107

Retail Space For Lease Between Target and Walmart - Anchored by Hobby Lobby!

Highlights and Features:

- 2,326 sf to 5,650 sf contiguous retail/warehouse
- Great visibility
- Located at the busy lighted intersection of Robert & Lothenbach
- Pylon and exterior signage available
- Traffic Count: 30,000 vpd on Robert Street S
- Co-tenants: Boost Mobile, Great Health Nutrition, PJS Alterations, The UPS Store, MetroPCS, Cost Cutters, Pho Saigon and Mr. Bill's Auto Detail
- Potential uses are deli, pizza, clothing, insurance, staffing companies, American/Ethnic restaurants and many more

Space Available:

- Suite 1682A: 2,360 sf
- Suite 1682B: 2,326 sf
- Suite 1726: 1,082 sf (office/whs space/garage door)
- Suites 1682A, 1682B and 1726: up to 5,650 sf contiguous
- 2018 CAM: \$3.41 psf and Tax: \$3.88 psf



Christianson & Company
COMMERCIAL REAL ESTATE SERVICES

www.SpaceAvailableMN.com

LAURA GILL

612.310.5399

laura@christiansonandco.com

MARY LINDELL

612.747.9854

mary@christiansonandco.com

This information is accurate as of the date of printing and is subject to change without notice. All information is deemed accurate, but cannot be guaranteed.

www.SpaceAvailableMN.com

Giving developers, business owners and commercial real estate investors the gifts of experience and personal attention.

Suite 1682A

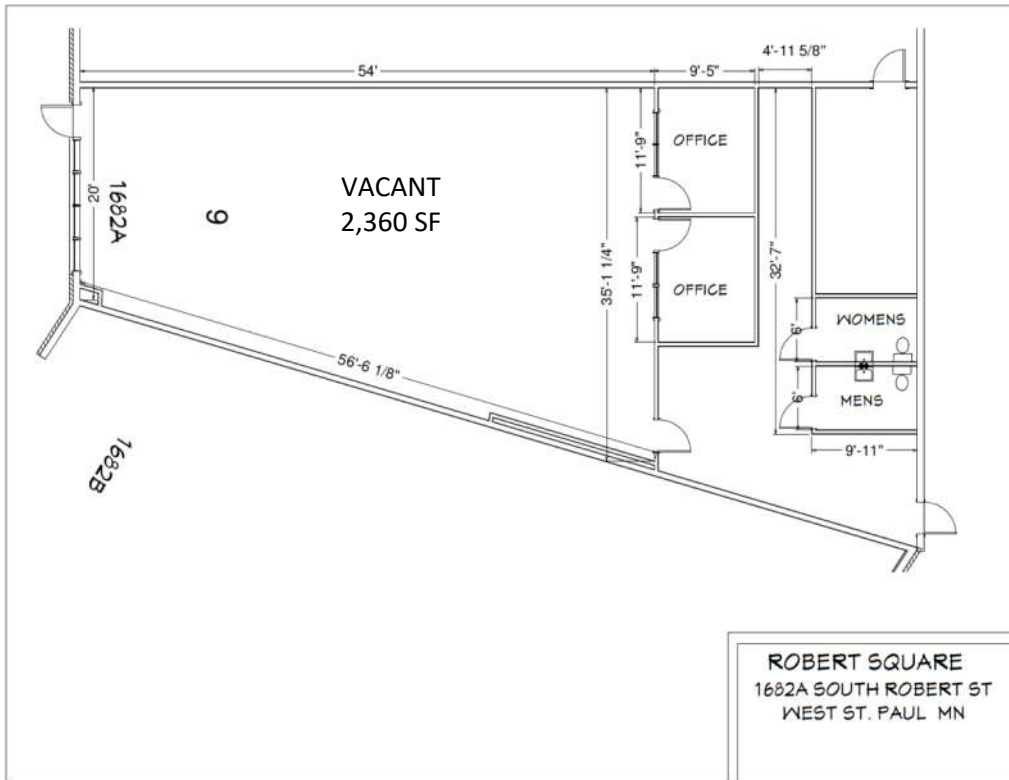

South End Site Plan

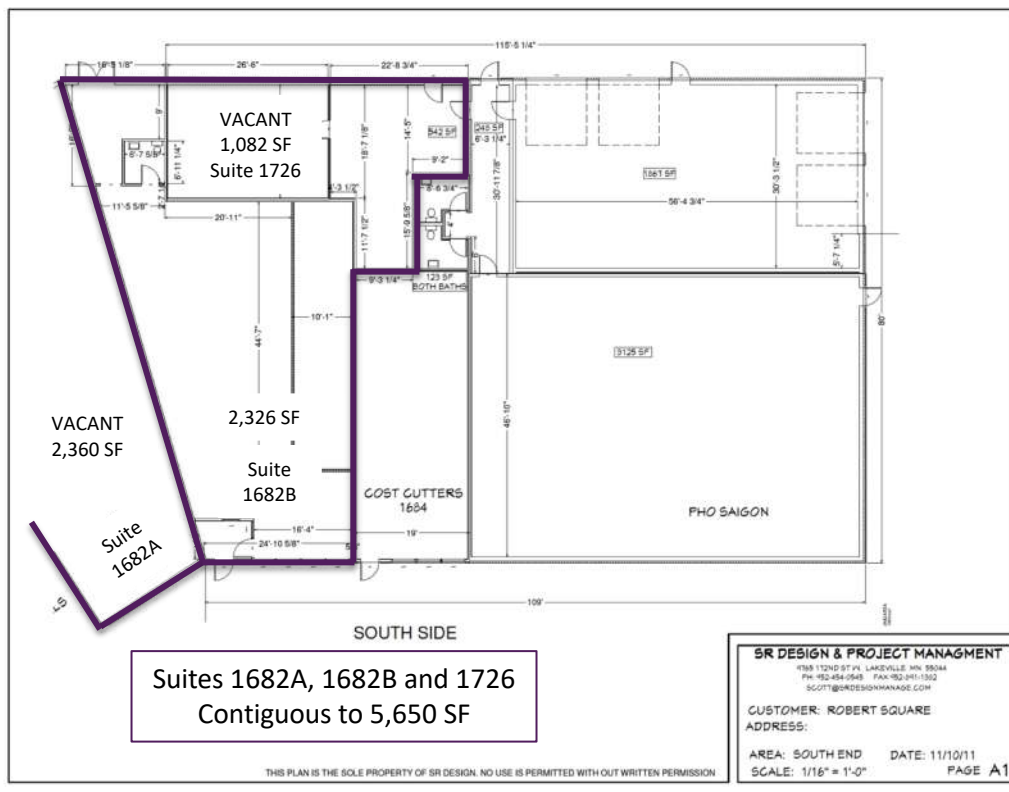

This information is accurate as of the date of printing and is subject to change without notice. All information is deemed accurate, but cannot be guaranteed.

Map

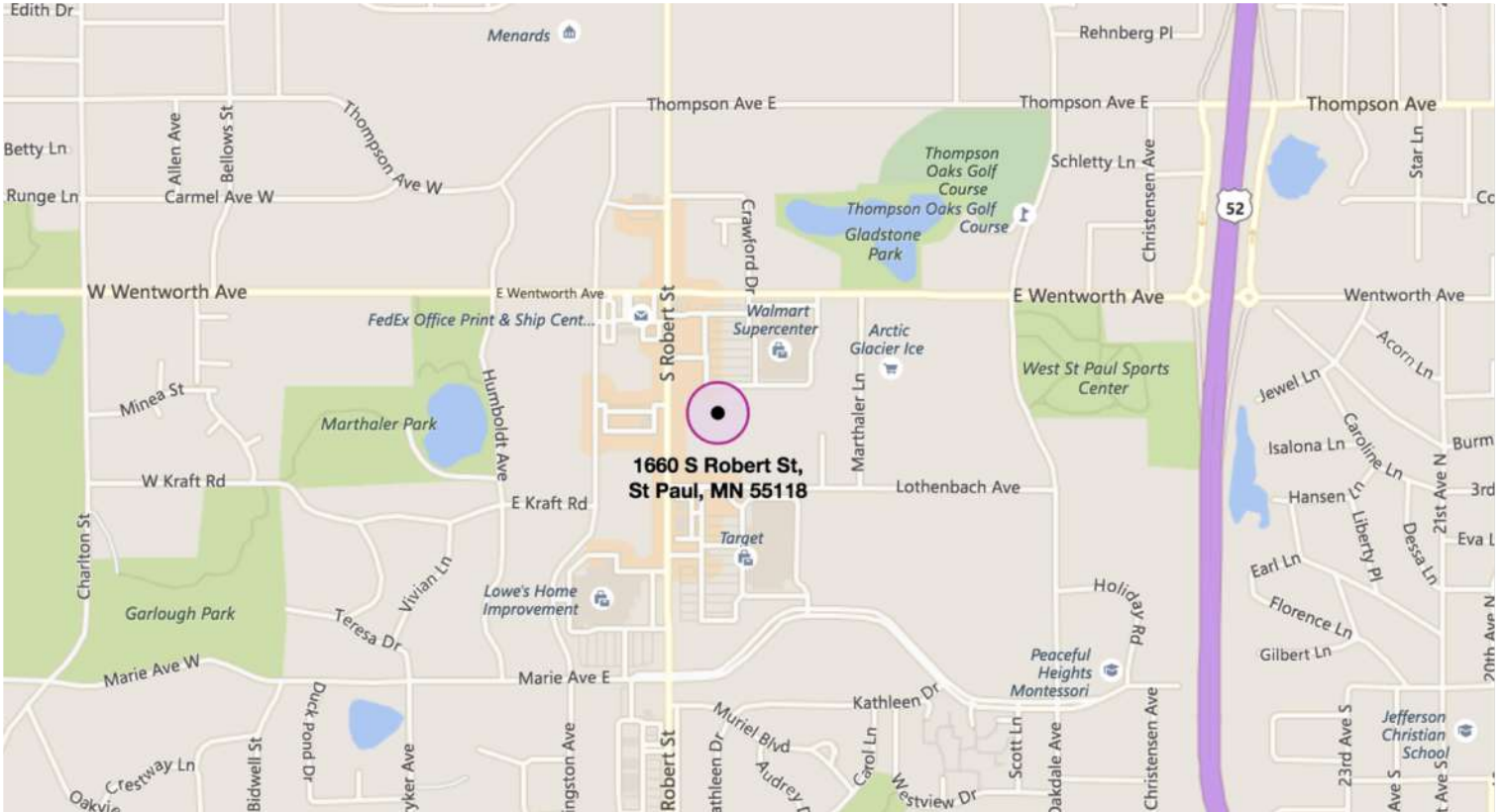

Aerial



This information is accurate as of the date of printing and is subject to change without notice. All information is deemed accurate, but cannot be guaranteed.