



2600 East 26th Street | Minneapolis, MN 55406

Up To 11,000 SF Of Contemporary Office Space For Lease!

2600 26th Street is a contemporary, sophisticated office building in the vibrant Seward Neighborhood located along the Mississippi River in south Minneapolis.



Highlights and Features:

- High image office facility
- Immaculate interior design
- 2 stories
- Built in 1999
- Ample parking
- Easy access to downtown Minneapolis, the University, and Saint Paul
- Easy access to I-94, I-35W, and Highway 62
- Close proximity to shops, restaurants, the Seward Co-op, arts and cultural organizations and Blue Line Metro Transit

Space Available:

- Main Level: Approximately 5,000 SF of contemporary office space, consisting of a shared reception area, several private offices, 2 conference rooms, kitchen, open office area as well as an outdoor patio
- Lease Rate: \$18.00 psf to \$22.00 psf Gross
- Lower Level: 6,000 sf with high ceilings and windows (can be built out according to tenants specifications)
- Lease Rate: \$14.00 psf Gross



Christianson & Company
COMMERCIAL REAL ESTATE SERVICES
www.SpaceAvailableMN.com

SABINE SHEA

612.203.5946

sabine@christiansonandco.com

This information is accurate as of the date of printing and is subject to change without notice. All information is deemed accurate, but cannot be guaranteed.

www.SpaceAvailableMN.com

Giving developers, business owners and commercial real estate investors the gifts of experience and personal attention.

Interior Photo



Interior Photo



This information is accurate as of the date of printing and is subject to change without notice. All information is deemed accurate, but cannot be guaranteed.

www.SpaceAvailableMN.com

Giving developers, business owners and commercial real estate investors the gifts of experience and personal attention.

Main Level Plan

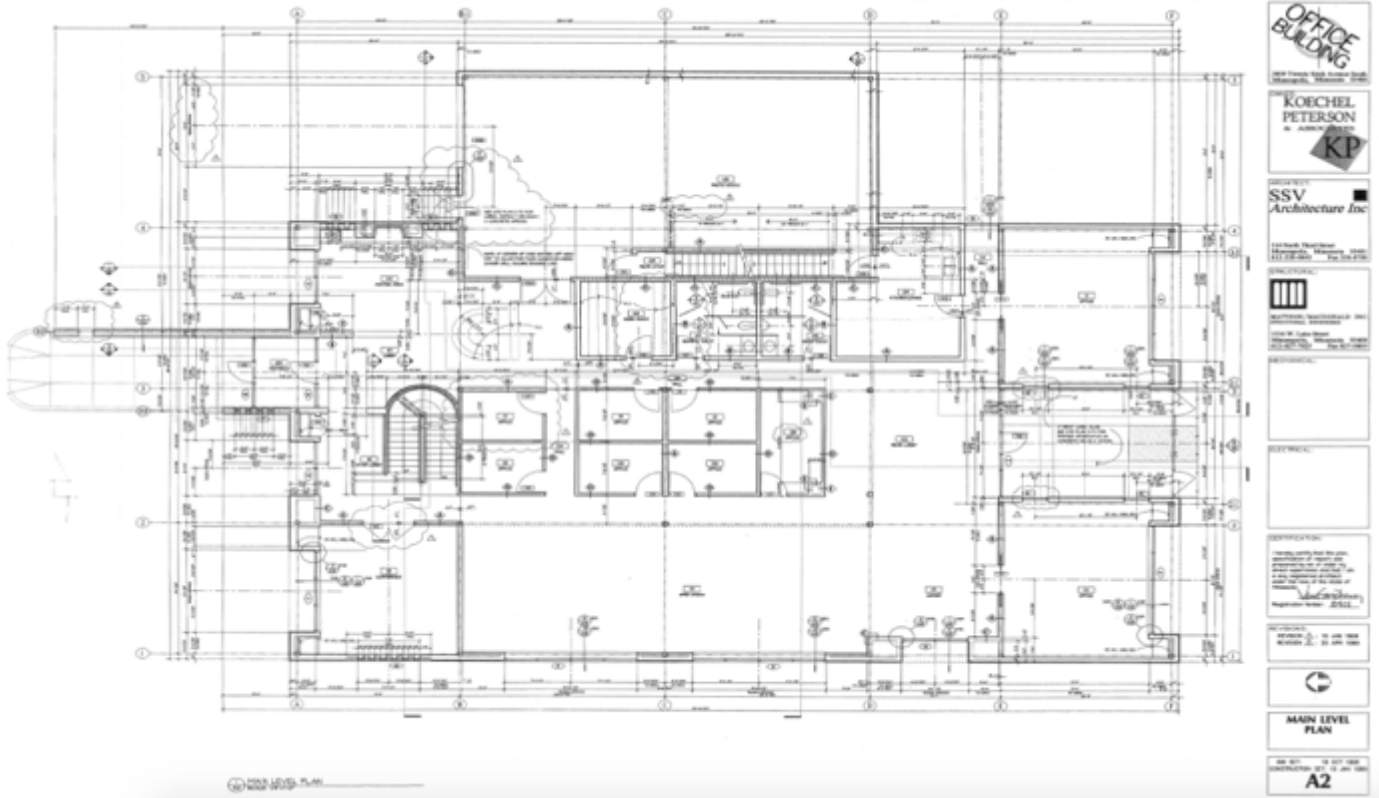

Lower Level Plan

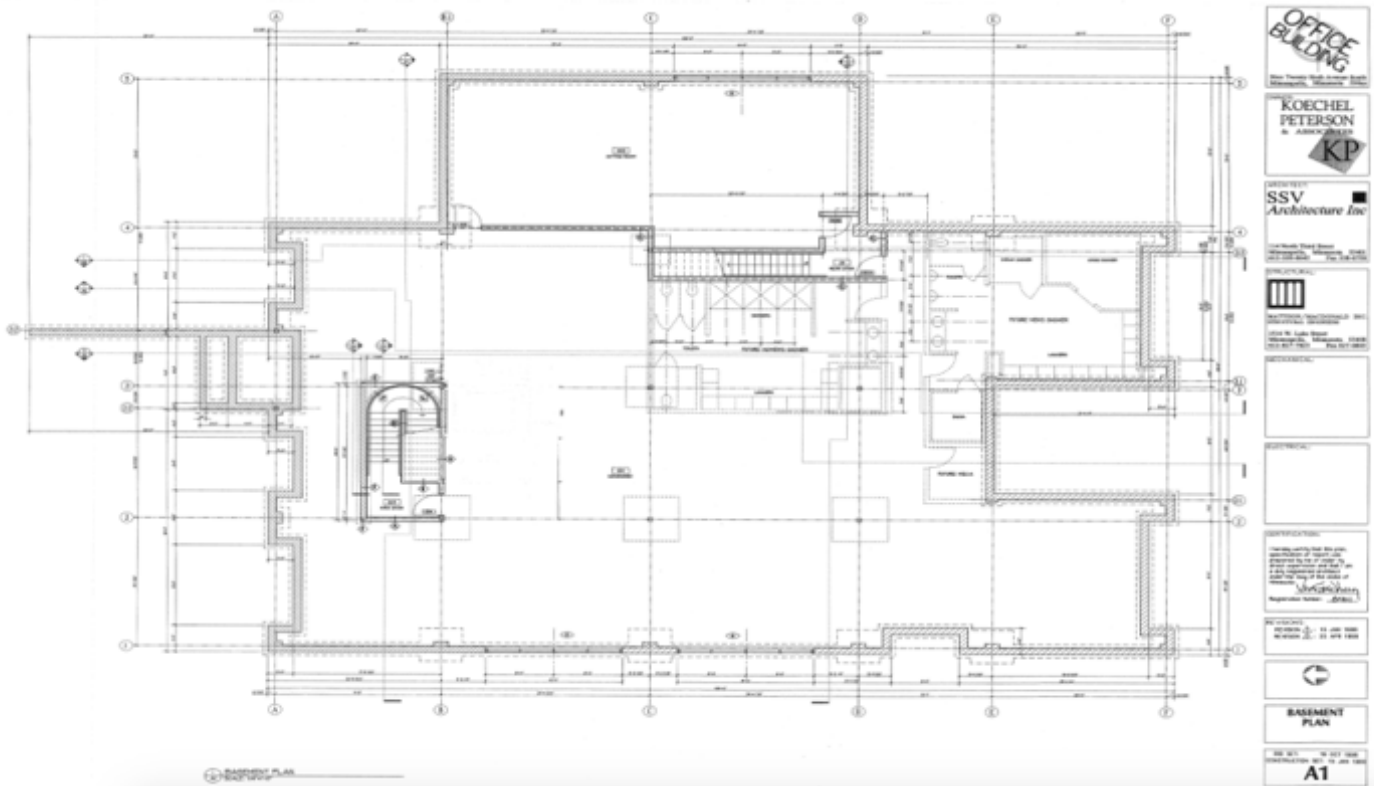

This information is accurate as of the date of printing and is subject to change without notice. All information is deemed accurate, but cannot be guaranteed.